



Cascade Valley Hospital

330 S. Stillaguamish Ave., Arlington



Directions from I-5:

Exit #208 to WA-530
Continue for 3.8 miles
Turn right onto WA-9
Turn left onto E. Highland Dr.
Turn left onto S. Stillaguamish Ave.
Hospital will be on the left



1st Floor

Imaging.....	A
MRI Building.....	B
Laboratory Services.....	C
Medical Records.....	G
Diabetes Education.....	H
Registration.....	I
Patient Advocate.....	I
Clinical Observation Unit.....	M
Emergency Department.....	O

Additional Floors →

- Emergency Room & After Hours Entrance
- Information
- Restroom
- Cascade Elevator A
- Olympic Elevator B
- Gift Shop

All parking lots provide handicap parking spaces. Tobacco-Free Campus



Cascade Valley Hospital

330 S. Stillaguamish Ave., Arlington

Additional Floors

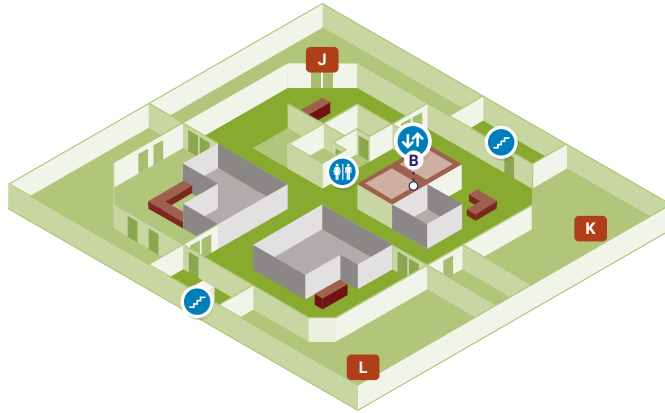

3rd Floor

- Surgical Care..... J
- Acute Care..... K
- Critical Care..... L

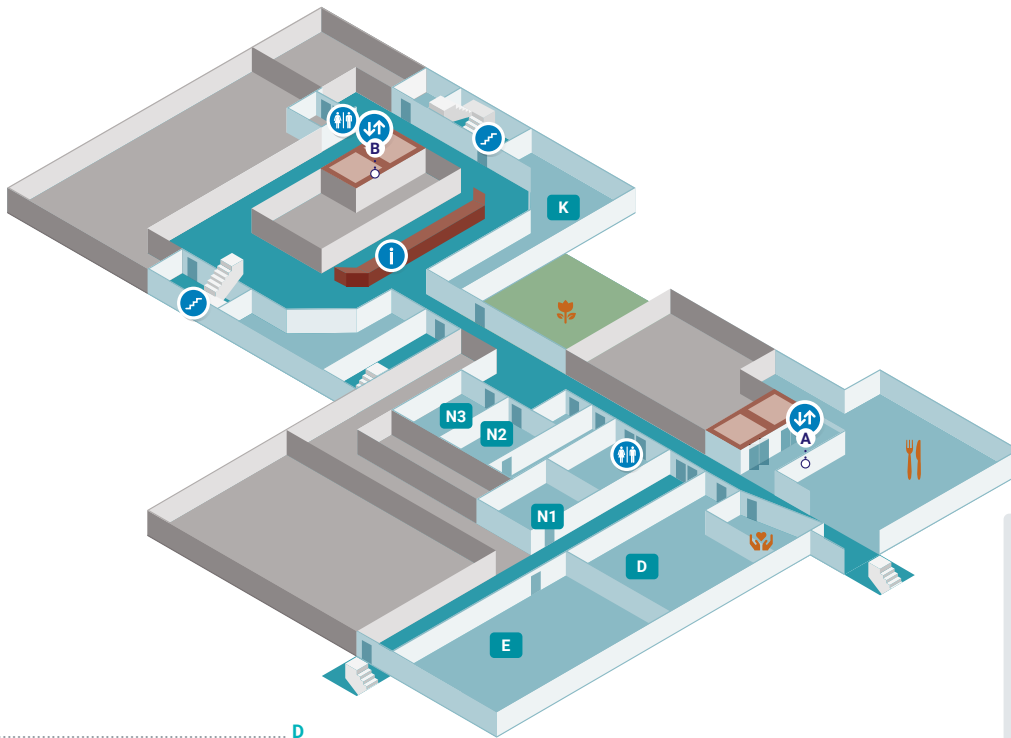

2nd Floor

- Cardiopulmonary..... D
- Outpatient Physical Therapy..... E
- Acute Care..... K
- Pilchuck Conference Room..... N1
- Rainier Conference Room A..... N2
- Rainier Conference Room B..... N3

- Information
- Restroom
- Cascade Elevator A
- Olympic Elevator B
- Café
- Reflection Room
- Garden